

Drester 2600

Manual Gun Cleaner for conventional paints

The Drester 2600 is the complete manual Gun Cleaner for efficient cleaning of spray guns and other tools, which have been used with conventional paints. It has a wash brush which is fed with recirculating solvent and a nozzle in the lid for rinse with clean solvent. You can spray out the gun through a funnel in the lid and dry it with an air gun which is fitted on the side of the machine. The Drester 2600 is equipped with the unique Drester Teflon Diaphragm pump, specifically designed for use in Gun Cleaners. Automatic extraction protects the operator from hazardous fumes and improves the working environment. The Drester 2600 meets international demands and safety regulations. The Gun Cleaner can be combined with the Drester Recycler and Docking Unit RDX to the fully automatic solvent handling system Drester Dynamic Triple.



DRESTER

when results count



Foot pedal for activating the nozzle for clean rinse.

Foot pedal for prewash with the brush.

Air Connection

Through an integral airline on the side of the unit, the spray gun is supplied with compressed air for spray out of the gun.

Built-in Extraction Unit

Drester 2600 is equipped with an air powered extraction unit that operates when the lid is open. It efficiently protects the operator from harmful fumes.

Clean Rinse

An integral nozzle in the lid is fed with clean solvent for rinsing.

Brush

The machine has a cleaning brush which is fed with recirculating solvent for efficient manual cleaning.

Spray out Funnel

Solvent goes back into the machine and fumes are removed by the extraction unit when spraying out the spray gun through the funnel in the lid.

Wash Basin

The wash basin is made of galvanized steel without any welding seams. The working platform can easily be removed when cleaning the washing compartment.

The Pump

The Drester 2600 is equipped with the powerful Drester Teflon Diaphragm pump for reliable operation. The pump is activated by pressing a foot pedal.

Accessories

When using extremely large drums, there is a Hose Extension Kit and a Cover Plate (if the machine is extended) as accessories. Please contact your Drester distributor for further information.

Technical Data

Working pressure: 5-12 bar (100-180 psi)
 Air consumption: 250 l/min (9 c.f.m.)
 Extraction capacity: 140 m³/h (82 c.f.m.)
 with 15 m (49 ft) extraction duct.
 180 m³/h (106 c.f.m.)
 with 5 m (16 ft) extraction duct.
 Extractor diameter: 125 mm (5")
 Weight (net): 30 kg (67 lb)

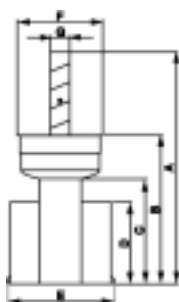

A: 1545 mm *	(60 3/4")	E: 700 mm	(27 1/2")
B: 990 mm *	(39")	F: 563 mm	(22")
C: 720 mm *	(28 1/2")	G: 125 mm	(5")

(Max. drum height)

* Extendable with 100 mm (4 ") with optional extra No. 9140, Cover Plate

© Hedson Technologies AB



HEHSON TECHNOLOGIES AB
 Hammarvägen 4
 SE-232 37 ARLÖV
 Tel +46 40 534200 Fax +46 40 432901
 www.hedson.se