

○ Avec ou sans mécanique
With or without mechanical elements
Con o senza parti meccaniche
Mit oder ohne Aggregate
Con ó sin mecanica desmontada

REP.	REFERENCE	PDS	NB	MZ
83	819.7083	1,2	2	
84	819.7084	3,9	1	142
85	819.7085	3,9	1	141
86	819.7086	2,7	1	
87	819.7087	2,7	1	
89	819.7089	4,5	1	140
90	819.7090	3,7	1	
91	819.7091	3,7	1	

	M 6-60 M 12-25 M 12-70	2 2 2
--	------------------------------	-------------

complément au
complementary set to
complemento al
zusatz zu **819.310**

819.314

28 Kg 22.09.2010 438-D-34A

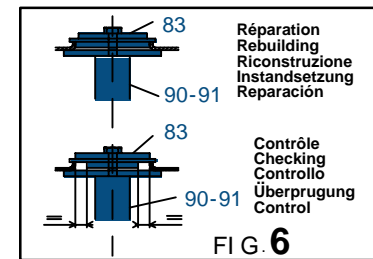
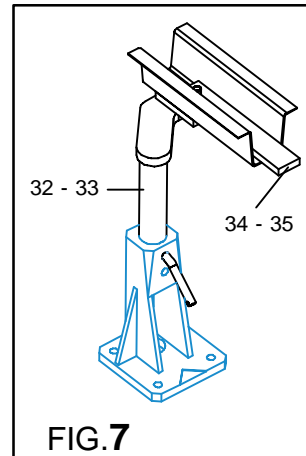
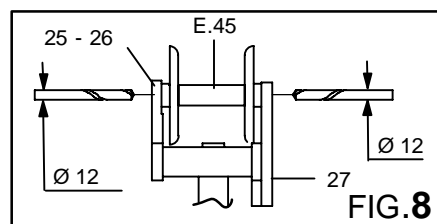
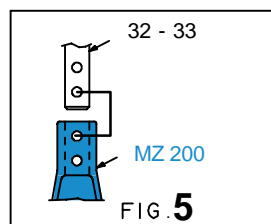
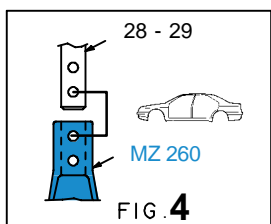
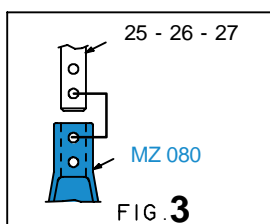
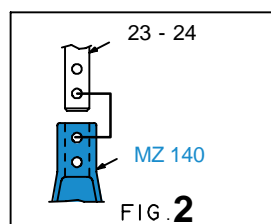
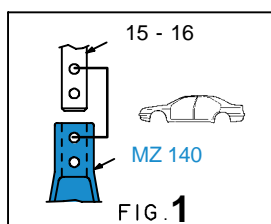
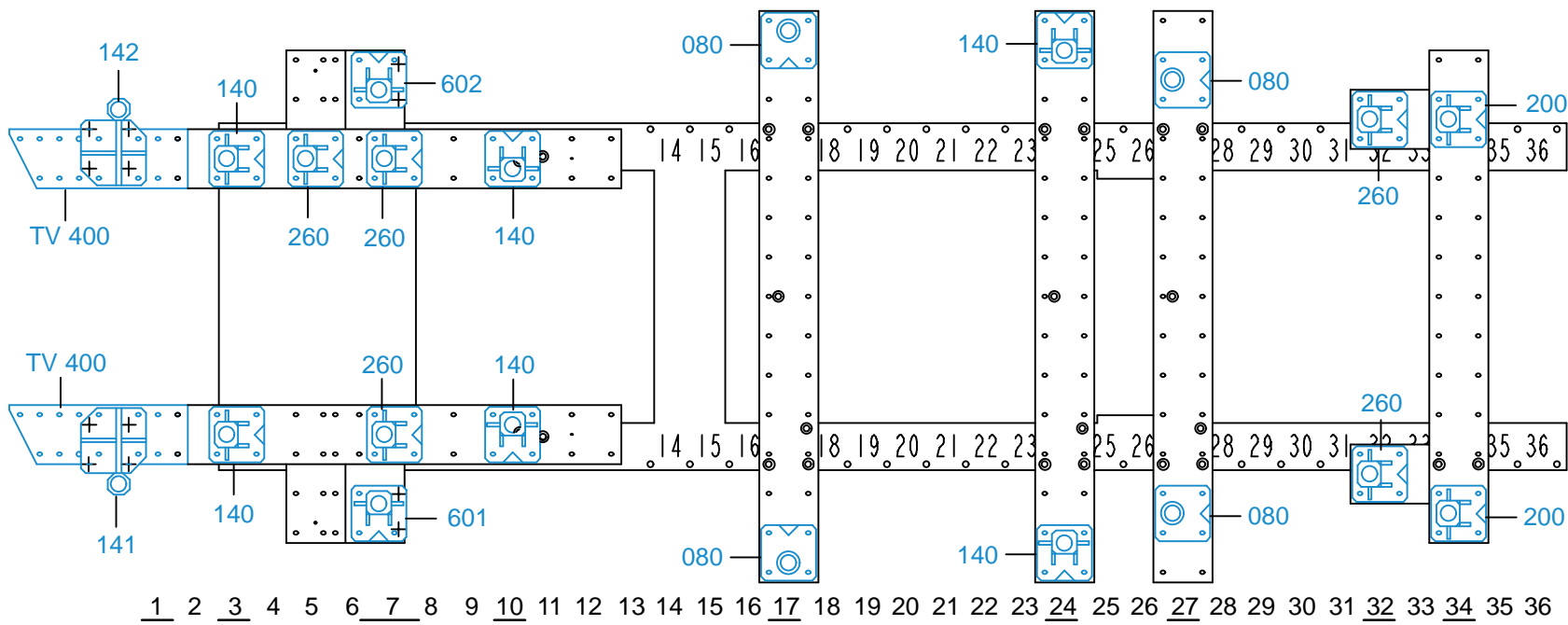

819.314-RVA3-1 01

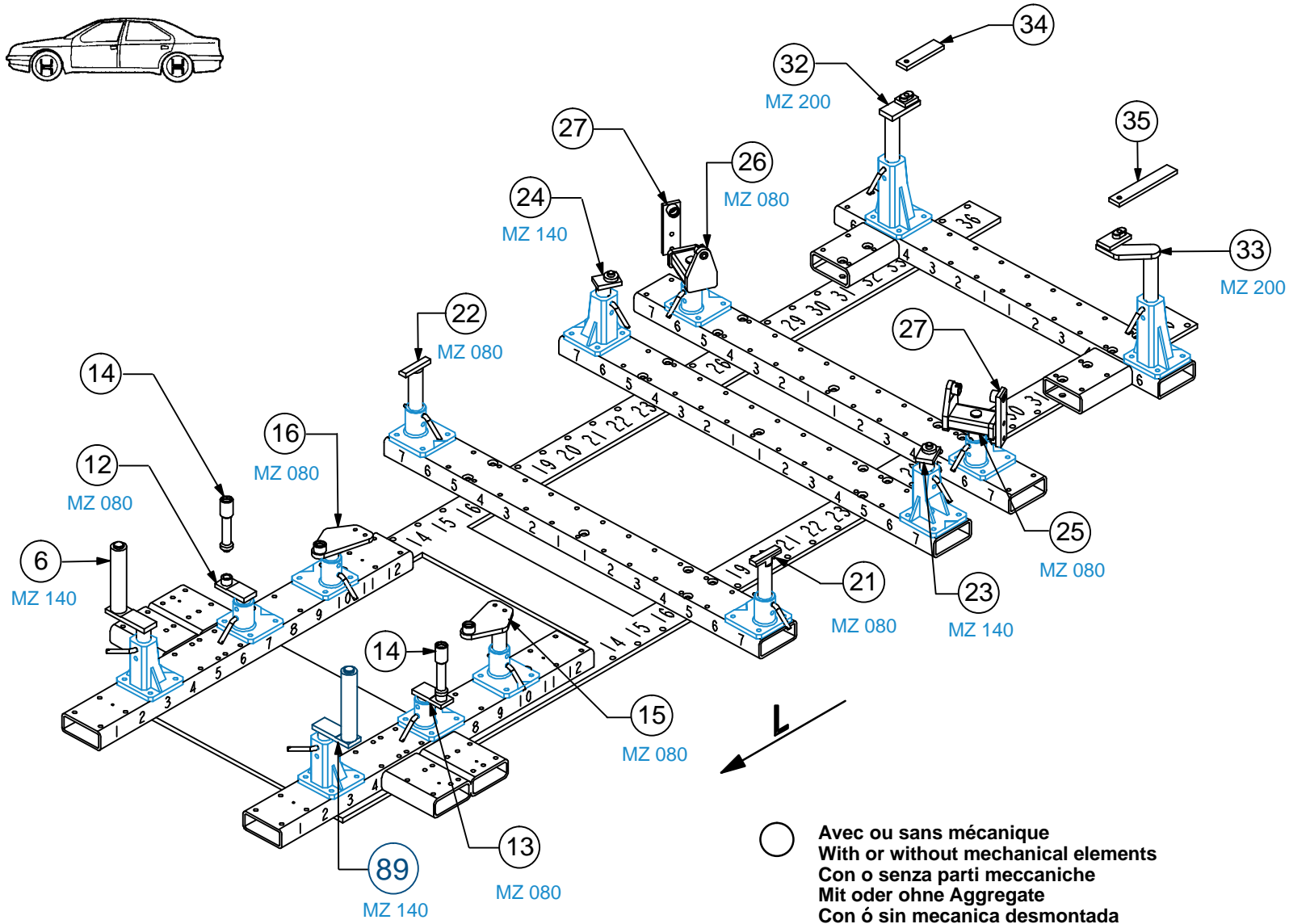
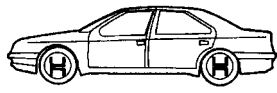

○ Avec ou sans mécanique
With or without mechanical elements
Con o senza parti meccaniche
Mit oder ohne Aggregate
Con ó sin mecanica desmontada



819.314

28 Kg 22.09.2010 438-D-34B

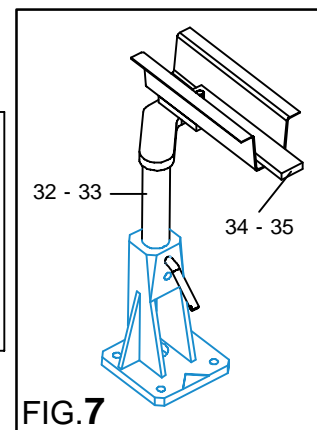
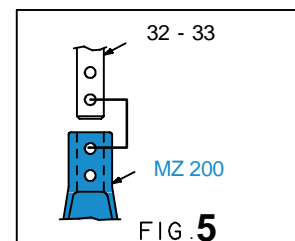
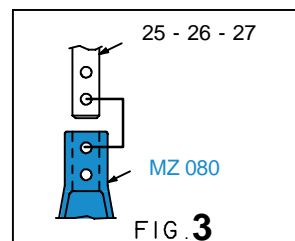
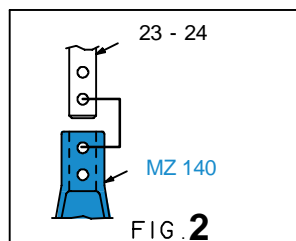
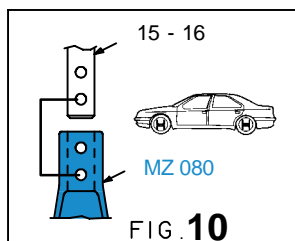
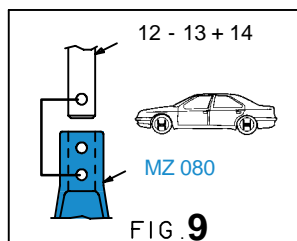
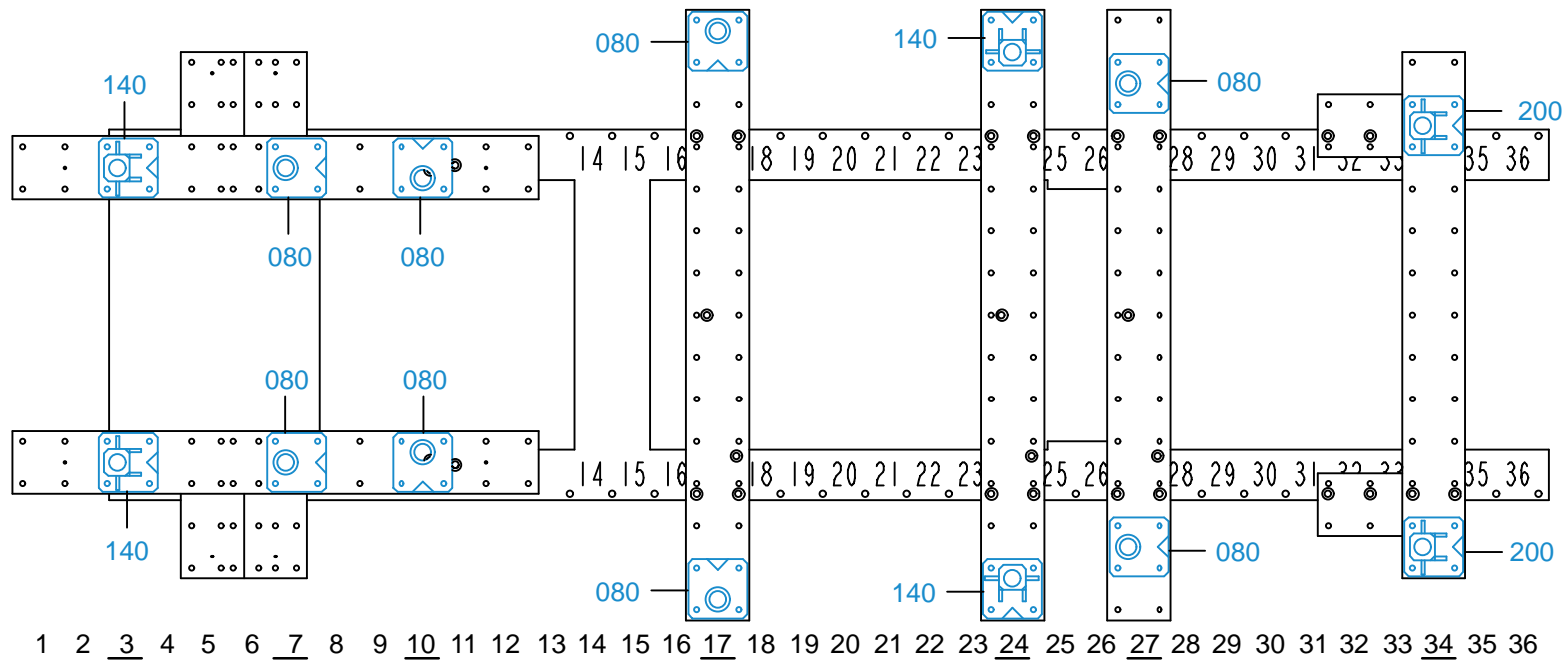

819.314-RVA3-1 01